

Industrial Space Available

111-115 Castle Road
Secaucus, New Jersey

Units Available: Unit A: 29,523 SF
Unit B: 22,108 SF

Rental: Upon Request

Possession: Unit A: Nov. 1, 2019
Unit B: August 1, 2019

Term: 5 year minimum

Floor Load (Warehouse): 250 lbs psf

Clear Ceiling Height: 22'-0" to 23'-10"

Column Spacing: 40'-0" x 40'-0"

Loading Docks:

Unit A: Three (3) 8' x 8' overhead doors
Unit B: Two (2) 8' x 8' overhead doors
One (1) 8' x 12' overhead door

Utilities:

Unit A: 700 amps, 3-phase, 4-wire,
480/277 volts

Unit B: 200 amps, 3-phase, 4-wire,
120/208 volts

Comments:

- Prime industrial building located off Route 3 and the New Jersey Turnpike in the Harmon Cove Industrial Park. The building is within minutes of Manhattan and Newark International Airport. The Garden State Parkway, Routes 17, 46, 1 & 9, and arteries to I-80, I-95 and I-280 are easily accessible.
- Business services, hotels, retail and restaurants are all nearby. Join corporate neighbors such as Gucci, Major League Baseball, Rose Brand, Midwest Medical Supply, Port Logistics Group & Macy's Inc.
- Many bus lines service Harmon Cove from New York's Port Authority and various parts of New Jersey. Train service is available to the entire Metro Region at nearby Secaucus Junction Train Station.

Economic Incentives:

- The New Jersey Economic Development Authority (EDA) offers a multitude of incentive programs to businesses located in New Jersey or that want to relocate to New Jersey. Visit www.njeda.com.

Move Your Business **closer** to the Port of NY & NJ
HARMON COVE – direct access to Exit 15X

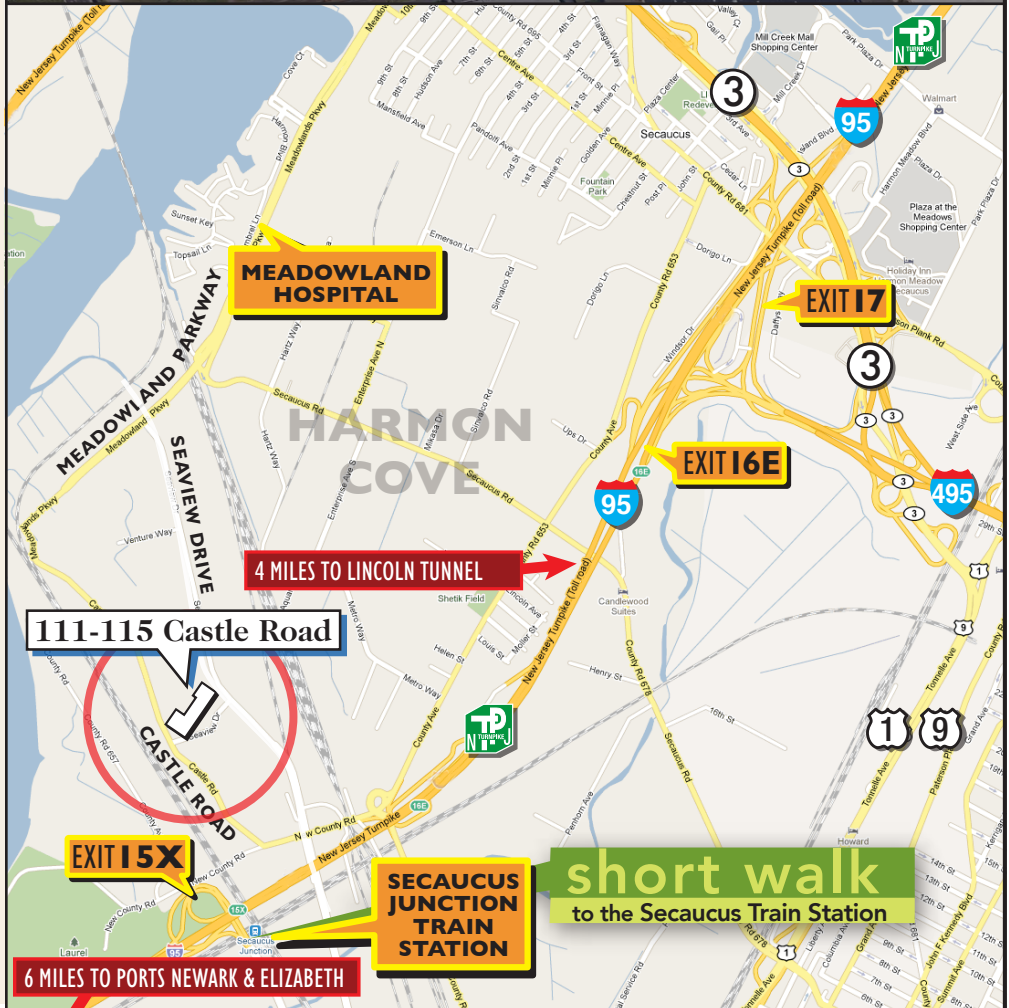

For leasing information, please contact:

Ernie Christoph • 201-272-5201
ernie.christoph@hartzmountain.com

Charlie Reese • 201-272-5202
charlie.reese@hartzmountain.com

Rick Vanderbeck • 201-272-5223
rick.vanderbeck@hartzmountain.com

Industrial Space Available

111-115 Castle Road
Secaucus, New Jersey

Move Your Business **closer** to the Port of NY & NJ
HARMON COVE – direct access to **Exit 15X**

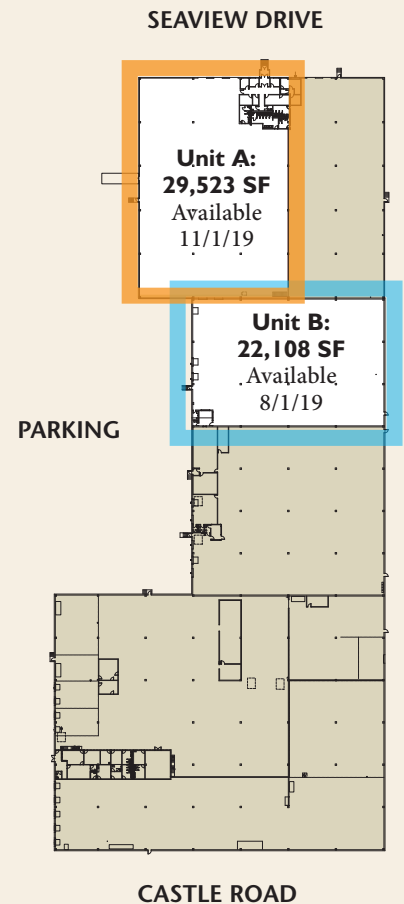
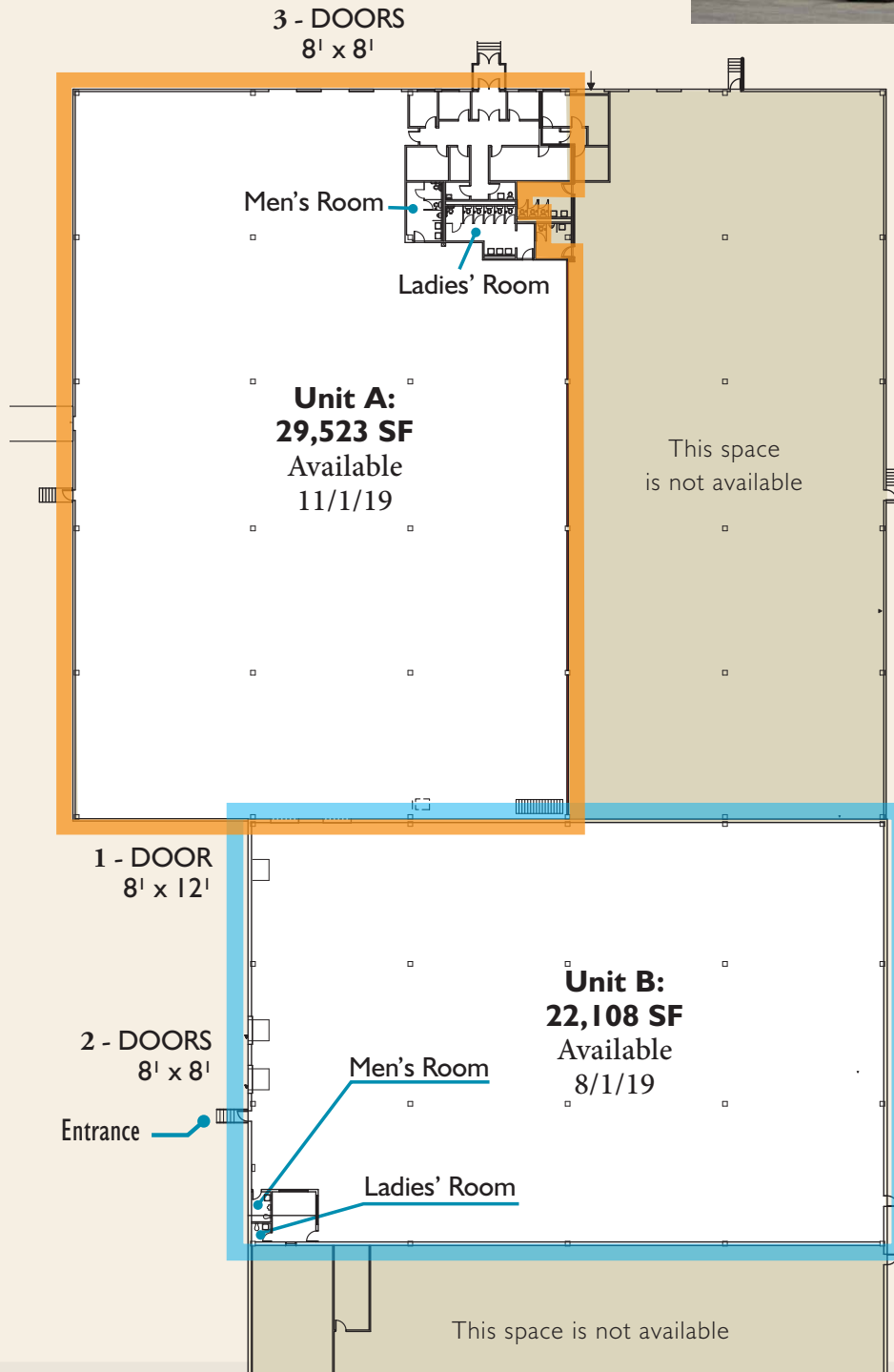

For leasing information, please contact:

Ernie Christoph • 201-272-5201
ernie.christoph@hartzmountain.com

Charlie Reese • 201-272-5202
charlie.reese@hartzmountain.com

Rick Vanderbeck • 201-272-5223
rick.vanderbeck@hartzmountain.com