

Industrial Warehouse Space Available

Move Your Business to **Northern NJ**

20-30 & 25 Continental Drive,
Wayne, New Jersey



-  20-30 Continental Drive
-  25 Continental Drive

TOTAL SPACE AVAILABLE:
192,997 SF

- **Loading Docks:**
Sixty-one (61) Exterior Doors

Mezzanine

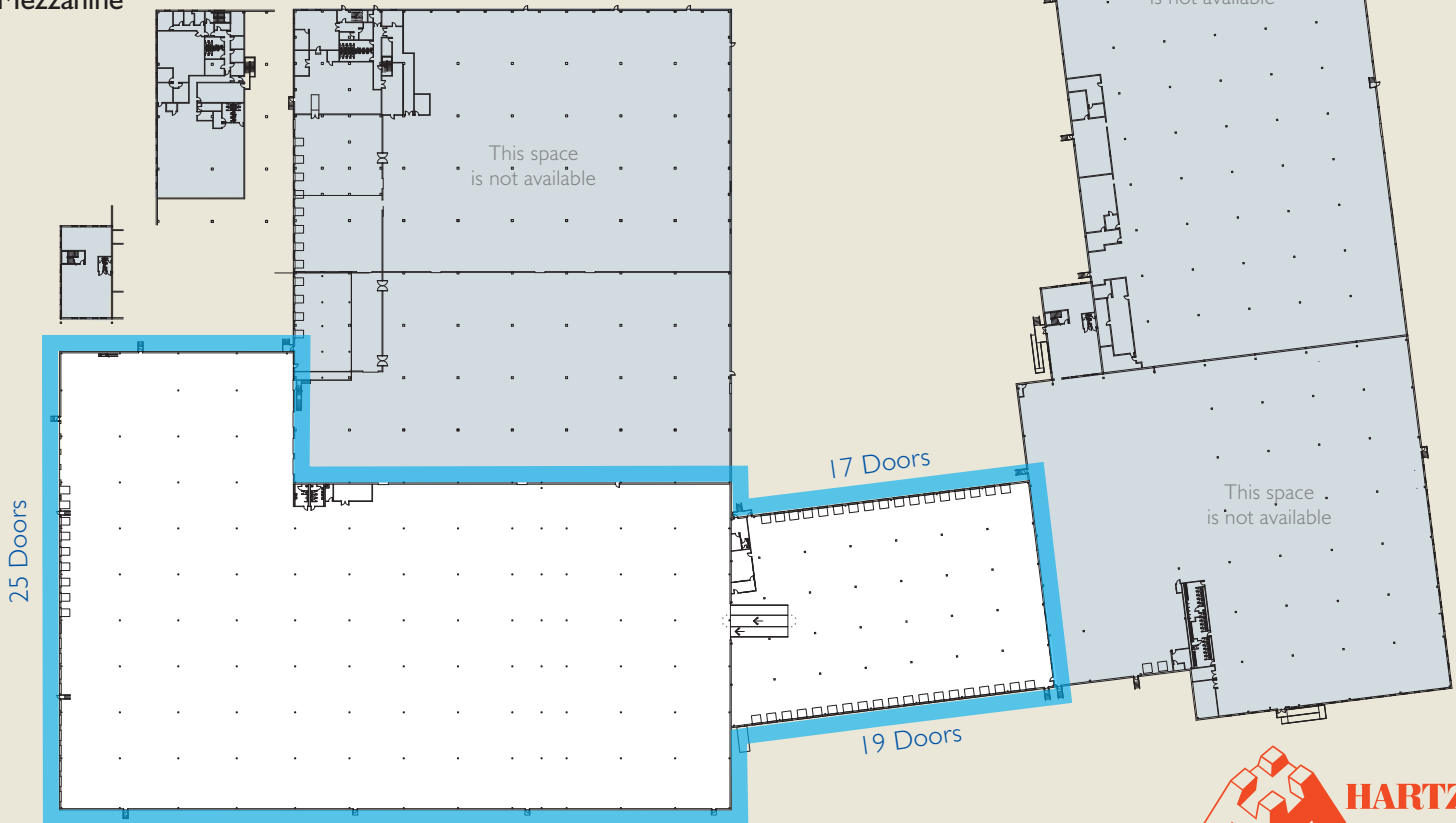

01/27/21



For leasing information, please contact:

Charlie Reese • 201-272-5202
charlie.reese@hartzmountain.com

Rick Vanderbeck • 201-272-5223
rick.vanderbeck@hartzmountain.com

Stephen Benoit • 201-272-5214
stephen.benoit@hartzmountain.com