

1200 HARBOR BLVD
Weehawken, New Jersey



9TH FLOOR PLAN

35,340 SF

Terms Upon Request

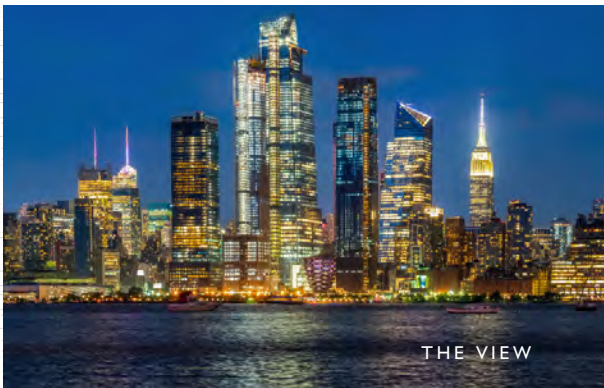

Space Available:

Third Floor: 34,104 SF
 Fourth Floor: 43,663 SF
 Eighth Floor: 34,420 SF & 13,956 SF
 Ninth Floor: 23,780 SF & 11,560 SF
 Tenth Floor: 23,270 SF & 4,742 SF
 Total: 189,495 SF

Rental Upon Request

Possession: Immediate

Term: 5 years minimum

Structure: Steel Frame

Exterior: Insulated glass curtain wall in thermal break system

Floor-to-Floor Heights:
13'-9"

Clear Ceiling Heights:
9'-0"

Floor Load: 100 LBS PSF

HVAC: Cooling tower, chiller, hot water baseboard, heat exchangers, VAV.

Fire Protection: Fully sprinklered, manual pull stations to activate voice evacuation system, automatic smoke alarm.

Elevators: Five (5) Passenger
One (1) Freight

Fiber: Multiple fiber providers are available, including Optimum, Verizon and ATT.

Electrical: Primary service 13.2 KV from PSE&G.

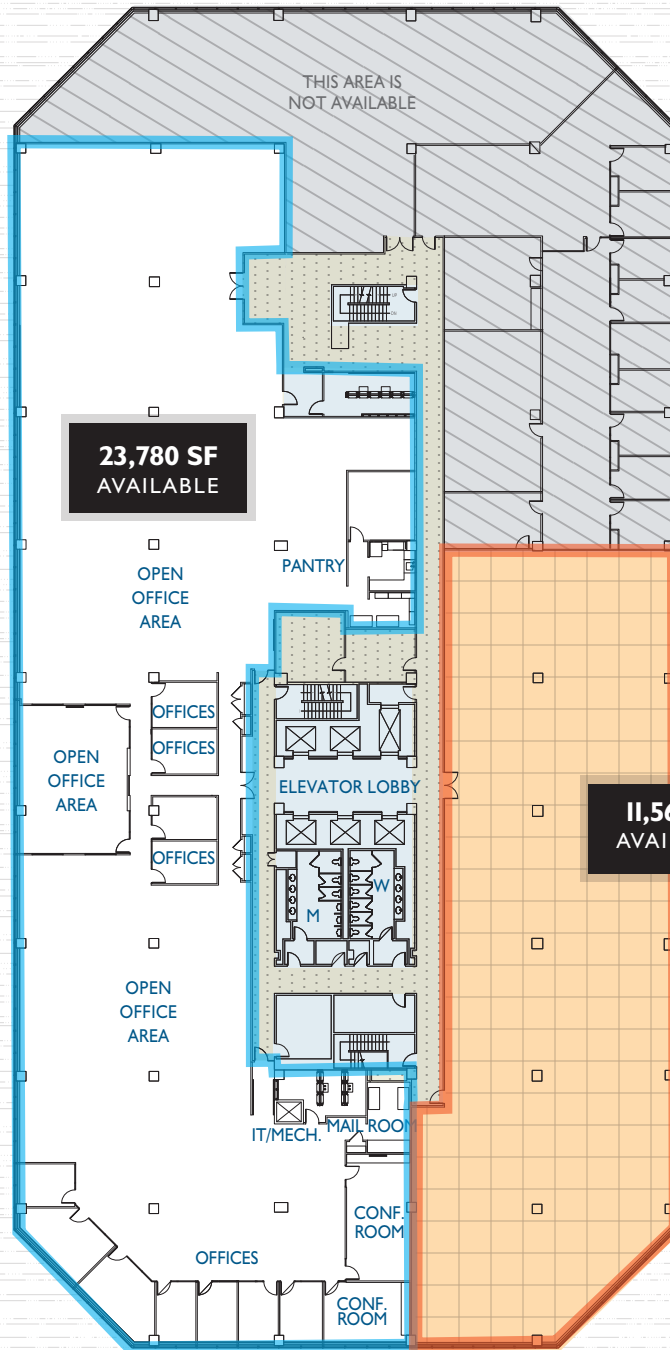

9th FLOOR

A Hartz Mountain Property

For further information or to schedule an inspection contact:

Charlie Reese • 201-272-5202
charlie.reese@hartzmountain.com

Rick Vanderbeck • 201-272-5223
rick.vanderbeck@hartzmountain.com

Stephen Benoit • 201-272-5214
stephen.benoit@hartzmountain.com

